

# QUALITY • VALUE • PERFORMANCE

## HOTJET II®

### PRODUCT BRIEF

07-01-2024



**10GPM @ 4,000 PSI**  
**35HP Vanguard Engine**

## HOTJET II®

### HOT & COLD WATER TRAILER JETTER

HotJet II Hot Water Trailer Mounted Sewer Jetters are engineered for the Professional Rooter, Plumber and Municipalities and will tackle the toughest blockages! We can custom engineer trailer mounted jetters with up to 18GPM output of hot water! Extremely effective in removing grease, soils, ice build ups, and blockages in drain lines from 2" to 12" – Easy to operate and priced right! Our Hot Jet Units are truly versatile workhorses – and they can be utilized as a dual purpose machine. First – as a powerful drain jetter and Second as a high pressure hot water cleaning unit to clean up properties. The unit includes our Exclusive Engineering Features and the Best Warranty in the Industry!

### MODEL NUMBERS:

HJ21040-35-SA-200

HJ21040-35-SA-330

HJ21040-35-TA-330

***Cleans 2" to 12" Lines***



# SINGLE AXLE



# TANDEM AXLE





**POWER TO THE PEOPLE**

You demanded more power — and we delivered. In 2005, Vanguard pioneered the BIG BLOCK engine to answer customers’ need for more power and performance for heavy-duty commercial applications. We continue listening to customers to develop power solutions and services that boost their bottom lines.

**THE VERSATILE POWER SOURCE**

Whether powering mud boats, commercial mowers, concrete trowels or more, BIG BLOCK engines continue to prove themselves in an array of demanding applications.

**POWER APPLICATION EXPERTS**

You don’t just get an engine from Vanguard — you get world-class application and mechanical engineering, in-depth training and superior technical support. Plus, our Power Application Centers allow us to solve specific customer challenges or prove how new innovations will perform across markets.

**ASSEMBLED IN THE U.S.A.**

Hand-assembled, meticulous craftsmanship. It’s not a lost art. It’s how we build each Vanguard BIG BLOCK engine right here in Auburn, Alabama. No short cuts. Just timeless American quality.

| KEY FEATURES                            | HIGHER DURABILITY | SUPERIOR AIR MANAGEMENT | REDUCED NOISE, VIBRATION & HARSHNESS |
|-----------------------------------------|-------------------|-------------------------|--------------------------------------|
| Heavy-Duty Cylinder & Sump              | ●                 |                         |                                      |
| High-Efficiency Head Design             | ●                 |                         |                                      |
| Forged Connecting Rods                  | ●                 |                         |                                      |
| High-Capacity Oil Pump                  | ●                 |                         |                                      |
| Cast Aluminum Valve Covers              | ●                 |                         | ●                                    |
| Dynamically Balanced Crankshaft         | ●                 |                         | ●                                    |
| Automotive Material Pistons             | ●                 |                         |                                      |
| Cyclonic Air Cleaner                    | ●                 | ●                       |                                      |
| Metal Rotating Screen                   |                   | ●                       |                                      |
| Controls Inspection Panel               |                   | ●                       |                                      |
| High-Flow Blower Housing & Static Guard |                   | ●                       |                                      |
| Balanced Flywheel                       |                   |                         | ●                                    |





# 66 Series, TSF

## Exclusive and innovative plunger guide design allows for even greater ceramic thickness

- Decreases possibility of cracking from thermal shock

## O-ring groove in crankcase vs cover

- Eases installation
- Increases strength of rear cover

## 31.04 oz. oil capacity

- Better cooling

## Fully anodized crankcase

- Better protection against elements

## Two sight glasses

- Easier to monitor oil levels
- One is bayonet style for easy replacement

## Oversized cylindrical roller bearings

- Higher load capabilities
- Increases life of pump

## Nickel plated plunger guides

- Smoothest possible surface results in longer seal life
- Superior strength

## 20 or 22 mm plungers

- Offers wider range of flows and pressures

## White ceramic plungers

- 99% alumina-ceramic
- Competitors plungers are only 97%
- Increases resistance to pitting and wear

## Positive aligning valve cap

- Makes changing valves fool proof
- Allows for "quiet" operation

## Oversized 2-piece white bronze connecting rods w/ 2, 8 mm bolts and special oil reservoirs

- Increases strength and stability
- Friction and heat reduction extends life

## Forged crankshaft

- Increases load potential
- Reduces fatigue

## Strongest, heaviest manifold on market (in this pump level)

- Increases strength and endurance
- Withstands higher pressures

## 3, 1/4" gage ports

- Allows mounting of multiple gauges

## Support ridges

- Adds strength and stability to manifold

## 8, 10 mm bolts

- Tightly mounts manifold to crankcase

## Improved low and high pressure seals

- Increases life
- Reduces maintenance

## Piston guide bushings in an exclusive teflon, graphite and bronze

- Superior strength
- Easily replaceable
- Smoothest possible surface results in longer seal life

## Innovative new valve cap design - O-ring placement prevents contact with water!

- Prevents O-ring extrusion
- Increases hydrostatic performance
- Valves easily serviced without dismantling manifold

OVERALL PUMP DIMENSIONS: 13.3" x 9.6" x 6.2"



# ENGINEERING: **HOTJET II**<sup>®</sup>

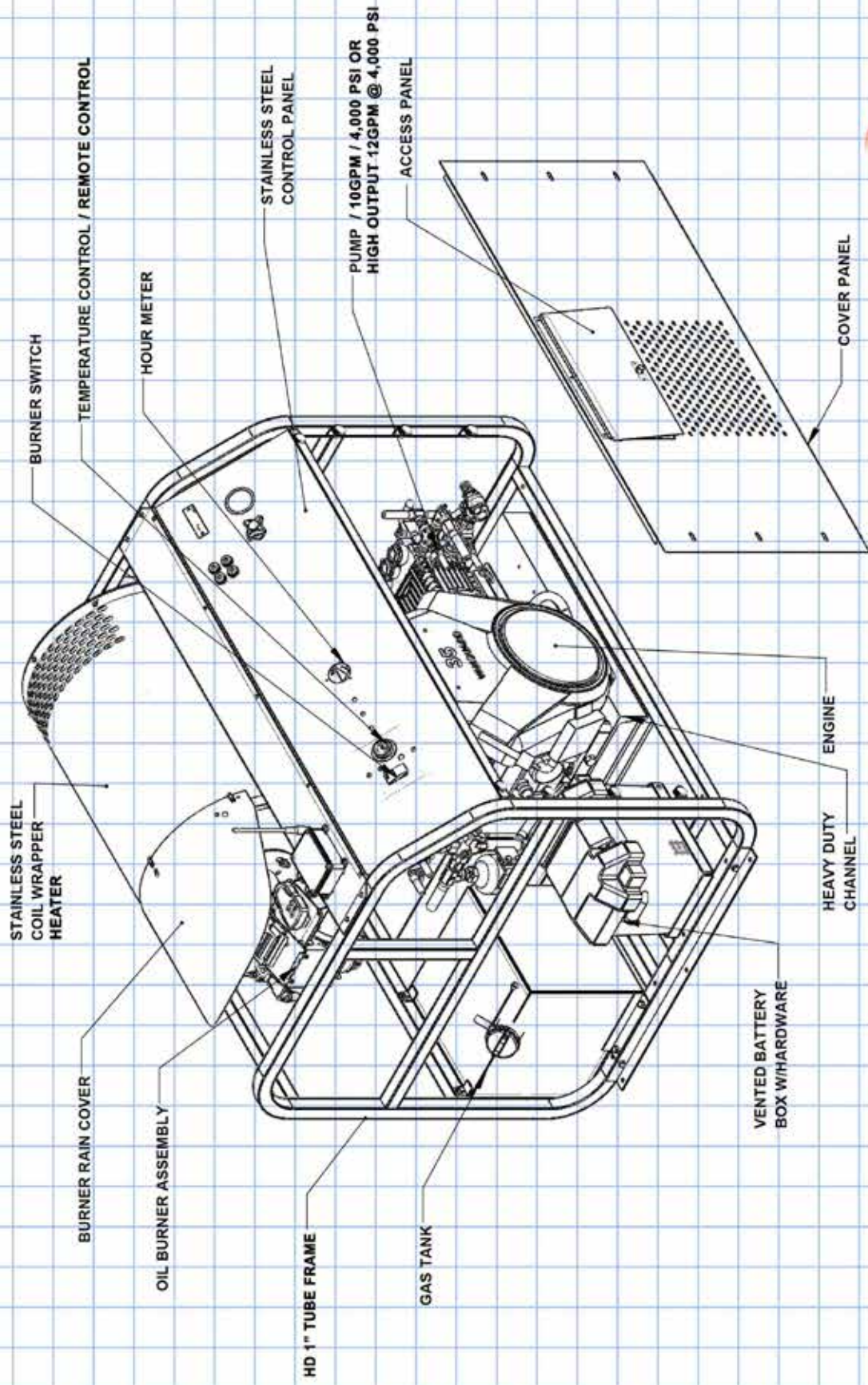



# HOTJET II EQUIPMENT SPECIFICATIONS



## TRAILER

- » Rugged, compact specially engineered trailer to haul the equipment and water load. Leaf Spring Axles cushion and distribute the weight for easy towing.
- » 5' x 12' Tandem Axel Diamond Plate Steel Deck
- » Dual 3,500 lb. Axles
- » Brakes on both axles
- » Weather Resistant Powder Coated Paint in YOUR CHOICE OF COLOR AT NO EXTRA CHARGE
- » Accepts 2 5/16" trailer ball for strength, or, D-Ring hitch
- » Fully Adjustable Hitch Height
- » DOT Compliant (Call for Information on Specific DOT Requirements for Your State)

## MECHANICS

- » 35 HP Vanguard Air-Cooled V-Twin Vertical Shaft Engine (Engineered by Toyota)
- » Full Throttle Controls Mounted at Rear
- » Large Vibration Isolators
- » EZ - Service Oil Drains (for pump and motor)
- » Tack and Hour Meters on engine
- » 1 - 12 gallon fuel tank
- » Three (3) year commercial warranty

- » (Available Upgrade Option) 38HP Kohler Command Pro Fuel Injected - 12GPM @ 4,000 PSI
- » (Available Upgrade Option) 24.8HP Kubota Diesel - 12 GPM @ 4,000 PSI

## PUMP

- » Premium Tri-Plex Pump 10 GPM @ 4,000 PSI (+/- 5%)
- » (Available Upgrade Option) 12GPM @ 4,000 PSI
- » Triple V-Belt driven for smooth operation
- » Pulsation "Jet" valve installed on pump

## BURNER SYSTEM

- » High Efficiency Becket Burner
- » Diesel Fueled Heater
- » HELICAL Heating Coil for Fast High Heat Rise
- » 498,000 BTU

## REMOTE CONTROL

- » Solid State Wireless Remote Control
- » Turn Engine On & Off
- » Turn Burner On & Off

# HOTJET II EQUIPMENT SPECIFICATIONS



## WATER TANK

- » 330 Gallon Lifetime Industrial Duty Water Tank
- » Quick Drain
- » Fast Fill Piping
- » Full Bypass System
- » Low Water Shut-Off System (Optional)
- » Tank Fill Shut-Off System (Optional)

## HOSES AND REELS

### *3/8" HD Jetter (2"-12" Lines)*

- » 300' 3/8" Non-Marking Smooth Finish High Pressure Jetter Hose
- » Heavy Duty Hydraulic Reel with Variable Speed (custom manufactured by Hannay)
- » Super Duty Reinforced Variable Speed with 120° Hose Guide Arm

## NOZZLES

- » Nozzles Custom Drilled to Maximize Torque for Higher Performance
- » Custom Drilled 3/8" Nozzle Set (4); Ram, Laser, Spinner, Degreaser/Deicer
- » Custom Drilled 3/8" Warthog WT-3/8-C Nozzle

## PORTABLE JUMPERJET (< 2" LINES)

- » 100' 1/4" JumperJet/Satellite Hose
- » Custom Foot Pedal for "hands free" Control
- » Hose Reel Cart or hand carry reel for 1/4" Hose

## WASH-DOWN SYSTEM HOSE

- » 100' "Clean" Wash Down High Pressure Hose with Quick Connect
- » Reinforced HD 5000 PSI Reel
- » High Pressure Gun and Wand Assembly
- » HP Nozzle Set (includes 2 each); 0°, 15°, 25°, 45°

## TOOL BOXES

- » 1- Heavy Duty Lockable Custom Aluminum Tongue Mount Tool Box
- » 1- Portable Craftsman Toolbox for accessories and tools
- » 2- Heavy Duty Lockable Custom Aluminum Side Mount Tool Boxes

## SAFETY PACKAGE

- » 10' Safety colored leader hose
- » Tiger Tail Hose Protector
- » 2 Safety Cones
- » Safety Vest
- » Insulated Gloves / Safety Glasses
- » Rear LED Lighting
- » Safety and Operations Video and Literature
- » Flashing Strobe Light

## MANUAL PACKAGE

- » Parts Book
- » Service Manual
- » Operator's Book



# THE BEST JETTERS DESERVE THE BEST TRAILERS

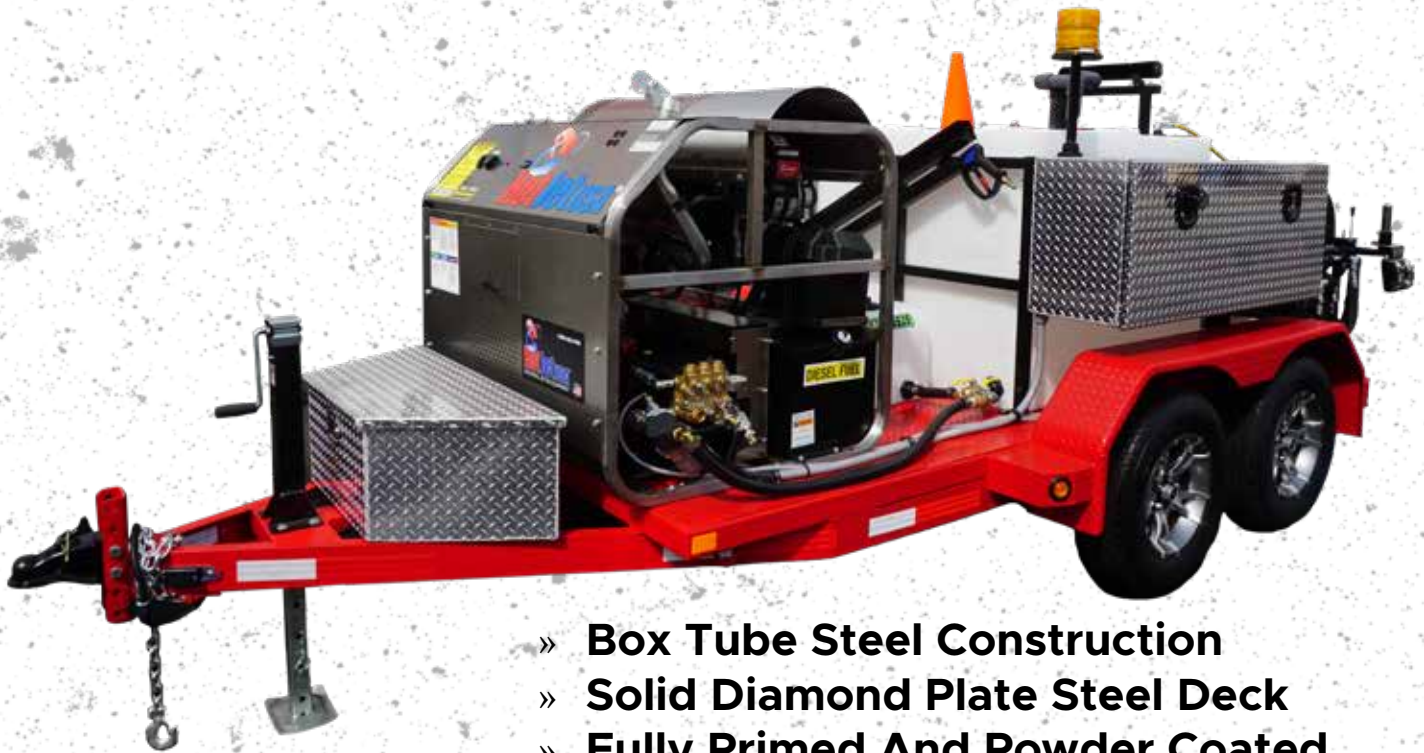

- » Box Tube Steel Construction
- » Solid Diamond Plate Steel Deck
- » Fully Primed And Powder Coated

## BUILT FOR YEARS OF SERVICE





# IT ALL STARTS WITH THE TRAILER



## TRAILER SPECIFICATIONS

Our HotJet trailers are custom engineered for extreme duty and are the best trailers made - PERIOD!

We are associate members of  
**NATM - National Association  
of Trailer Manufacturers**  
and we manufacture in  
compliance with their national  
engineering codes.



## FRAME

Our trailers feature a "Rock Solid" 3/16" tube frame (not 1/8") that extends the full length of the trailer. The frame is then welded on the HD C-Channel sub-frame. We directly weld this to our spring support shackles.

## TOP DECK

The top deck is full sheathed diamond plate steel decking which adds structural rigidity.

## AXLES

We use Dexter brand leaf spring axles. Leaf springs are proven for our applications. They cushion and distribute the weight loads. Each axle has electric brakes.

## PAINT / POWDER COAT

We use a premium pre-wash zinc hot-wash. This is followed by a Sherwin Williams primer coat that is exclusively made for powder coating. A Sherwin Williams premium powder coat paint that is engineered to resist corrosion and promote color consistency is then added.

## MISCELLANEOUS

We use HD fenders with step plates welded on both sides. The Ram Jack is super duty and rated to lift 8,000 lbs. All lights and markers are LED. Plug is standard 7-way.





# CHOOSE YOUR TRAILER COLOR!

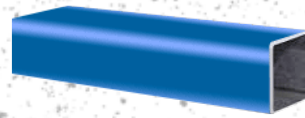

**Red, Black & Blue Standard Color Options**  
**Custom Paint Colors Available Upon Request - Cost Extra**





# CUSTOM SIGNAGE AVAILABLE



## ARTWORK REQUIREMENTS:

Custom signage is designed by our in-house graphic artist. Provide your logo/branding in high resolution VECTOR FORMAT (.ai, .eps or vector PDF) and we'll do the rest! A proof will be provided for review prior to print production.





2 - Solid State Remote Controls - **\$3,450.00 Value**

3 - HD Arkansas Safety Premium Tool Boxes - **\$2,980.00 Value**

1 - Super Duty Hydraulic Powered Hose Reel Upgrade - **\$2,190.00 Value**

1 - Custom Drilled Warthog Nozzle and a Complete Custom Drilled Nozzle Set - **\$1,500.00 Value**

1 - Complete Lateral Cleaning Package Includes Hose Reel, 100' of 1/4" Hose and HD Foot Control - **\$2,495.00 Value**

1 - Complete Power Wash Set-up includes 100' of HD Power Wash Hose - **\$1,780.00 Value**

FREE Attendance to Our Jetter Workshop All Inclusive (flights, meals, rooms, airport transportation) - **\$1,950.00 Value**

Soap Injection System and 1 - FREE CASE of our Premium Drain Line Additive - **\$590.00 Value**

FREE Signage & Artwork for Your New Trailer System - **\$750.00 Value**

#### HYDRAULIC SYSTEM:

- » Belt Driven
- » Large Reservoir To Keep The System Cool
- » Large Filter System
- » Easy To Run Hydraulic Controls



#### REMOTE CONTROLS:

- » Solid State
- » Best in the Business!